

DIMENSIONS FOR OVERALL HEIGHT AND LENGTH ARE APPROXIMATE

OVERALL HEIGHT = 100.25"

OVERALL WIDTH WITH RUB

RAILS & FENDERETTES = 95"

(5) TECNIQ S330 AMBER
MINI-LED MARKER LIGHTS

(7) WHELEN 600 SUPER LED WITH CLEAR LENSES
RED / RED / RED / WHITE / RED / RED / RED

OEM POWER
ADJUSTABLE
MIRRORS

FLASHING HEADLIGHTS W/
DAYTIME RUNNING LIGHTS

WHELEN 500 SERIES
RED SUPER LED LIGHTS
WITH CLEAR LENSES

(2) WHELEN SA315
SERIES SIREN
SPEAKERS BEHIND
GRILLE AREA

THIS DRAWING IS FOR REPRESENTATIONAL PURPOSES ONLY. DETAILS ARE CONCEPTUAL AND ARE SUBJECT TO CHANGE DURING DESIGN AND CONSTRUCTION
DIMENSIONS ARE APPROXIMATE UNLESS NOTED OTHERWISE TO MEET A SPECIFIC CUSTOMER NEED.



2014 FRONT EXTERIOR VIEW
EXPRESS-III/E-350 CHASSIS-GAS ENGINE ONLY

DATE:
08 APR 13

DWG. GLF REV. NR

DRAWING NO.

14EXE350-1

1:16

DIMENSIONS FOR OVERALL HEIGHT AND LENGTH ARE APPROXIMATE
 OVERALL HEIGHT = 100.25"
 OVERALL WIDTH WITH RUB
 RAILS & FENDERETTES = 95"
 FLOOR HEIGHT = 31"

(5) WHELEN 600 SUPER LED WARNING LIGHTS WITH CLEAR LENSES,
 (2) WHELEN 600 CLEAR HALOGEN LOAD LIGHTS:
 RED / RED / LOAD / AMBER / LOAD / RED / RED

(5) TECNIQ S330 RED
 MINI-LED MARKER LIGHTS

EXHAUST VENT

LOCATION FOR
 DOOR GRABBERS

LED LICENSE
 PLATE LIGHT

(1) EACH SIDE, WHELEN
 600 LED BRAKE/TAIL,
 600 LED TURN
 600 HALOGEN BACK-UP
 NOTE: MOUNT OUTBOARD AS
 FAR AS PRACTICAL

MUD FLAPS

INDEPENDENT BUMPER WITH
 NON-SKID FLIP-UP CENTER
 STEP AND COT PROTECTOR
 ON STEP EDGE

THIS DRAWING IS FOR REPRESENTATIONAL PURPOSES ONLY. DETAILS ARE CONCEPTUAL AND ARE SUBJECT TO CHANGE DURING DESIGN AND CONSTRUCTION
 DIMENSIONS ARE APPROXIMATE UNLESS NOTED OTHERWISE TO MEET A SPECIFIC CUSTOMER NEED.



2014 REAR EXTERIOR VIEW
 EXPRESS-III

1:16

DATE:
 08 APR 13
 DWG. GLF REV. NR

DRAWING NO.
 14EXE350-2

DIMENSIONS FOR OVERALL HEIGHT AND LENGTH ARE APPROXIMATE

OVERALL HEIGHT = 100.25"
 OVERALL LENGTH = 247.75"
 MODULE LENGTH = 144"

TECNIQ S330 RED MINI-LED MARKER LIGHT TO ALSO FLASH WITH TURN SIGNAL

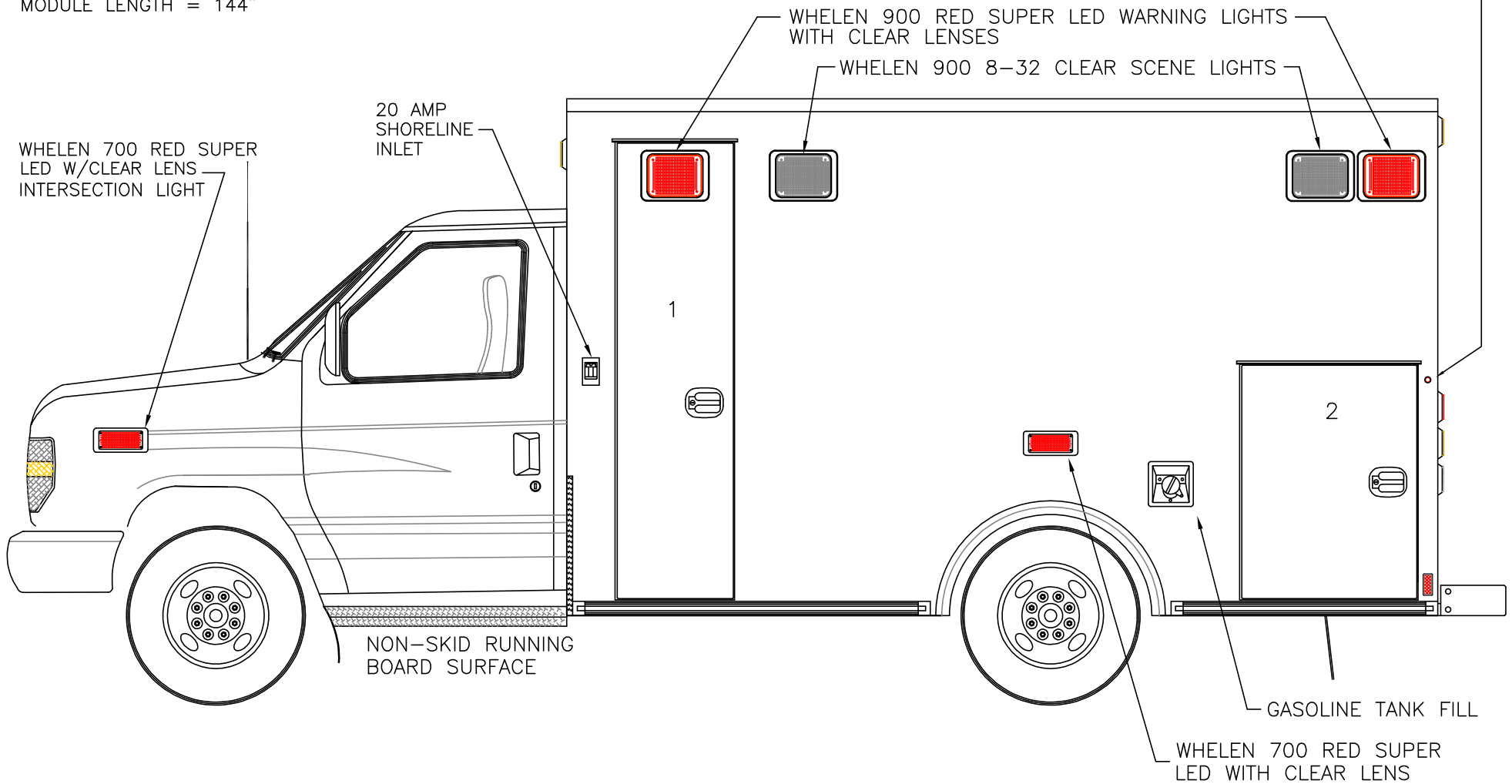

COMPARTMENT

O.S.S #1

CLEAR OPENING: 74.00h x 16.00w
 INSIDE DIMS: 75.00h x 22.75w x 18.50d
 BACKBOARD/SCOOP STORAGE

O.S.S #2

CLEAR OPENING: 37.50h x 26.00w
 INSIDE DIM'S.: 42.50h x 32.25w x 18.50d

THIS DRAWING IS FOR REPRESENTATIONAL PURPOSES ONLY. DETAILS ARE CONCEPTUAL AND ARE SUBJECT TO CHANGE DURING DESIGN AND CONSTRUCTION
 DIMENSIONS ARE APPROXIMATE UNLESS NOTED OTHERWISE TO MEET A SPECIFIC CUSTOMER NEED.



2014 STREETSIDE EXTERIOR VIEW
 EXPRESS-III/E-350

1:24

DATE:
08 APR 13
 DWG. REV.
GLF NR

DRAWING NO.
14EXE350-3

DIMENSIONS FOR OVERALL HEIGHT AND LENGTH ARE APPROXIMATE
 OVERALL HEIGHT = 100.25"
 OVERALL LENGTH = 247.75"
 MODULE LENGTH = 144"

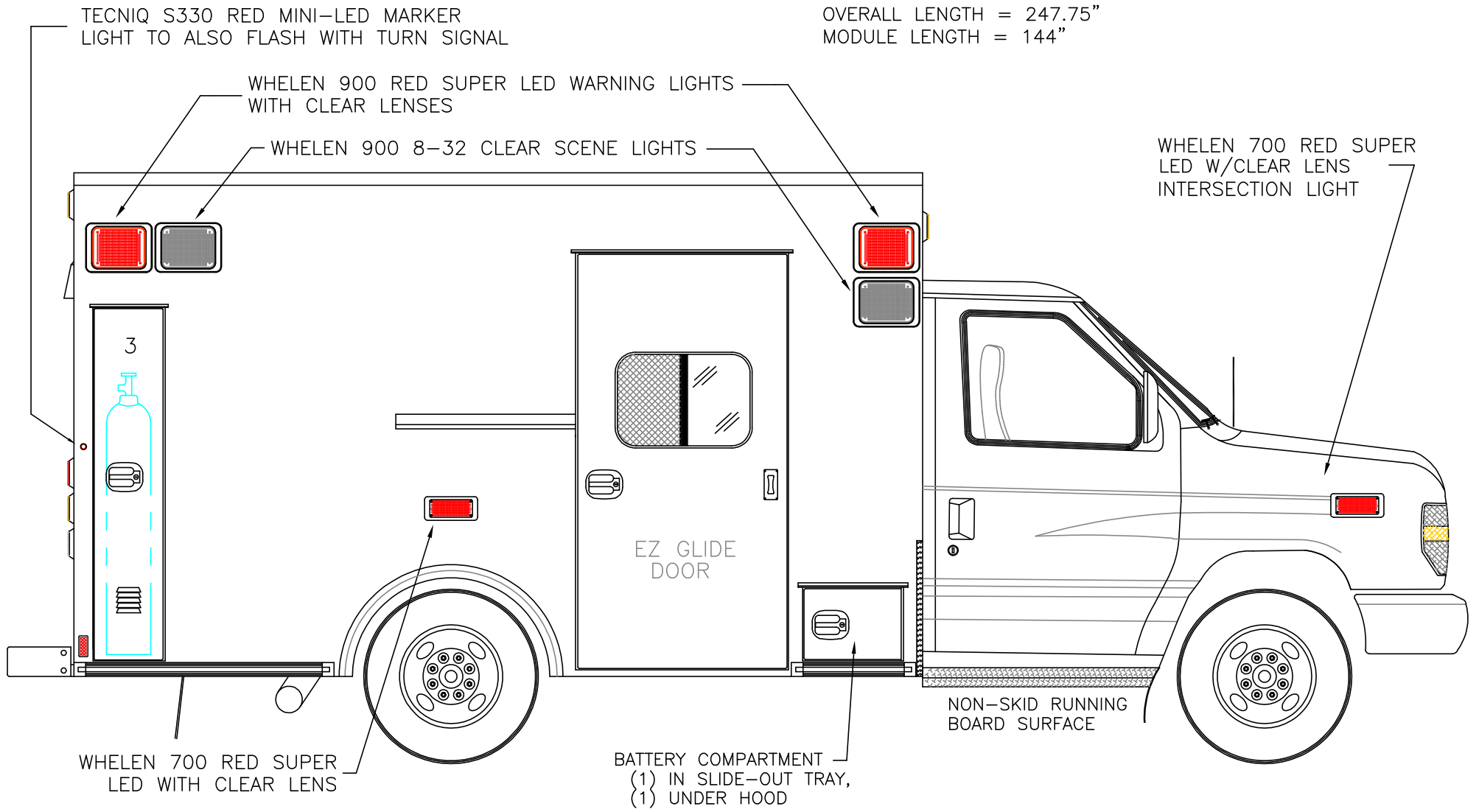

O.S.S #3
 CLEAR OPENING: 58.50h x 9.50w
 INSIDE DIM'S.: 59.25h x 12.00w x 15.00d
 OXYGEN COMPARTMENT FOR "M" OR "H" CYLINDER

THIS DRAWING IS FOR REPRESENTATIONAL PURPOSES ONLY. DETAILS ARE CONCEPTUAL AND ARE SUBJECT TO CHANGE DURING DESIGN AND CONSTRUCTION
 DIMENSIONS ARE APPROXIMATE UNLESS NOTED OTHERWISE TO MEET A SPECIFIC CUSTOMER NEED.



2014 CURB EXTERIOR VIEW
 EXPRESS-III/E-350

DATE: 08 APR 13		DRAWING NO. 14EXE350-4
DWG. GLF	REV. NR	

1:24

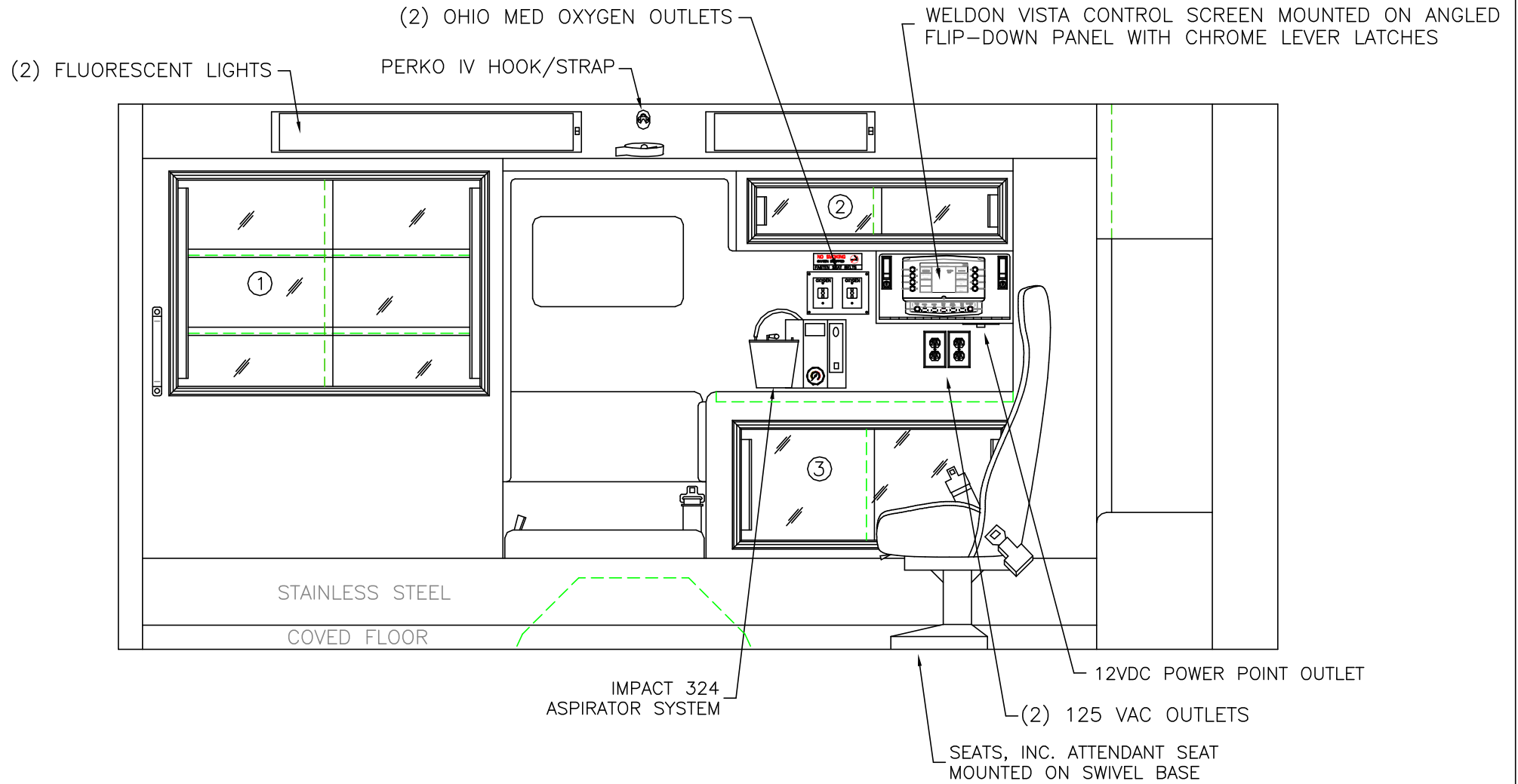

COMPARTMENT:

- #1 DOOR OPENING: 25.50h x 37.50w
INSIDE DIMS: 27.50h x 39.50w x 16.25d
(2) ADJUSTABLE SHELVES
- #2 DOOR OPENING: 5.75h x 30.00w
INSIDE DIMS: 8.50h x 31.75w x 15.00d
- #3 DOOR OPENING: 13.75h x 32.25w
INSIDE DIMS: 17.50h x 34.25w x 16.25d

CABINETS TO BE ALUMINUM
CABINET SHELF TRACK TO BE RECESSED

THIS DRAWING IS FOR REPRESENTATIONAL PURPOSES ONLY. DETAILS ARE CONCEPTUAL AND ARE SUBJECT TO CHANGE DURING DESIGN AND CONSTRUCTION DIMENSIONS ARE APPROXIMATE UNLESS NOTED OTHERWISE TO MEET A SPECIFIC CUSTOMER NEED.



2014 STREETSIDE INTERIOR WITH CPR SEAT
EXPRESS-III

1:18

DATE:	08 APR 13
DWG.	GLF
REV.	NR

DRAWING NO.	14EXE350-5
-------------	------------

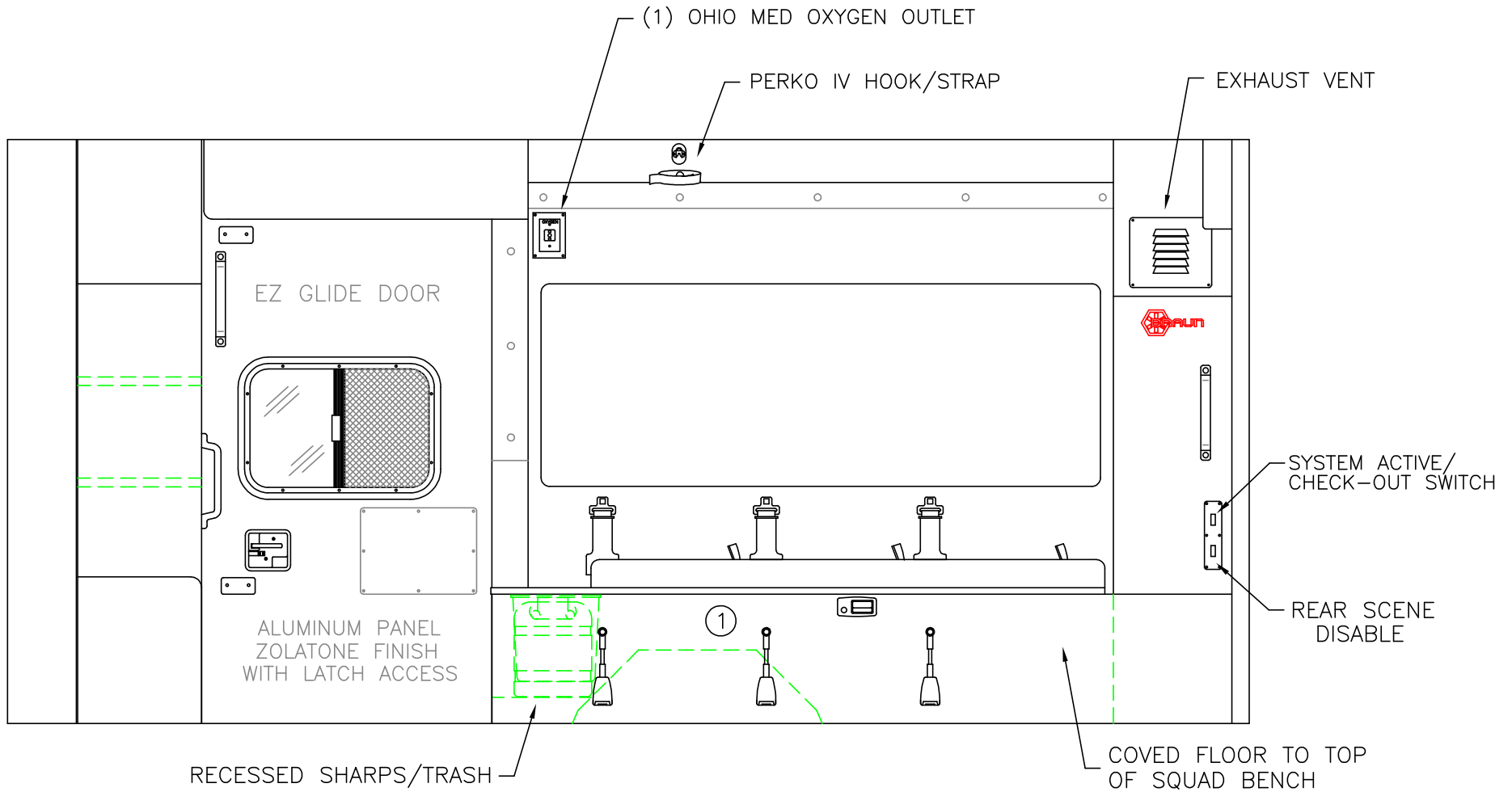

COMPARTMENT
 #1 INSIDE DIMS: 15.50h x 72.00w x 18.50d

CABINETS TO BE ALUMINUM

THIS DRAWING IS FOR REPRESENTATIONAL PURPOSES ONLY. DETAILS ARE CONCEPTUAL AND ARE SUBJECT TO CHANGE DURING DESIGN AND CONSTRUCTION DIMENSIONS ARE APPROXIMATE UNLESS NOTED OTHERWISE TO MEET A SPECIFIC CUSTOMER NEED.



2014 CURBSIDE INTERIOR VIEW
 EXPRESS-III

DATE: 08 APR 13		DRAWING NO.
DWG. GLF	REV. NR	14EXE350-6

1:18

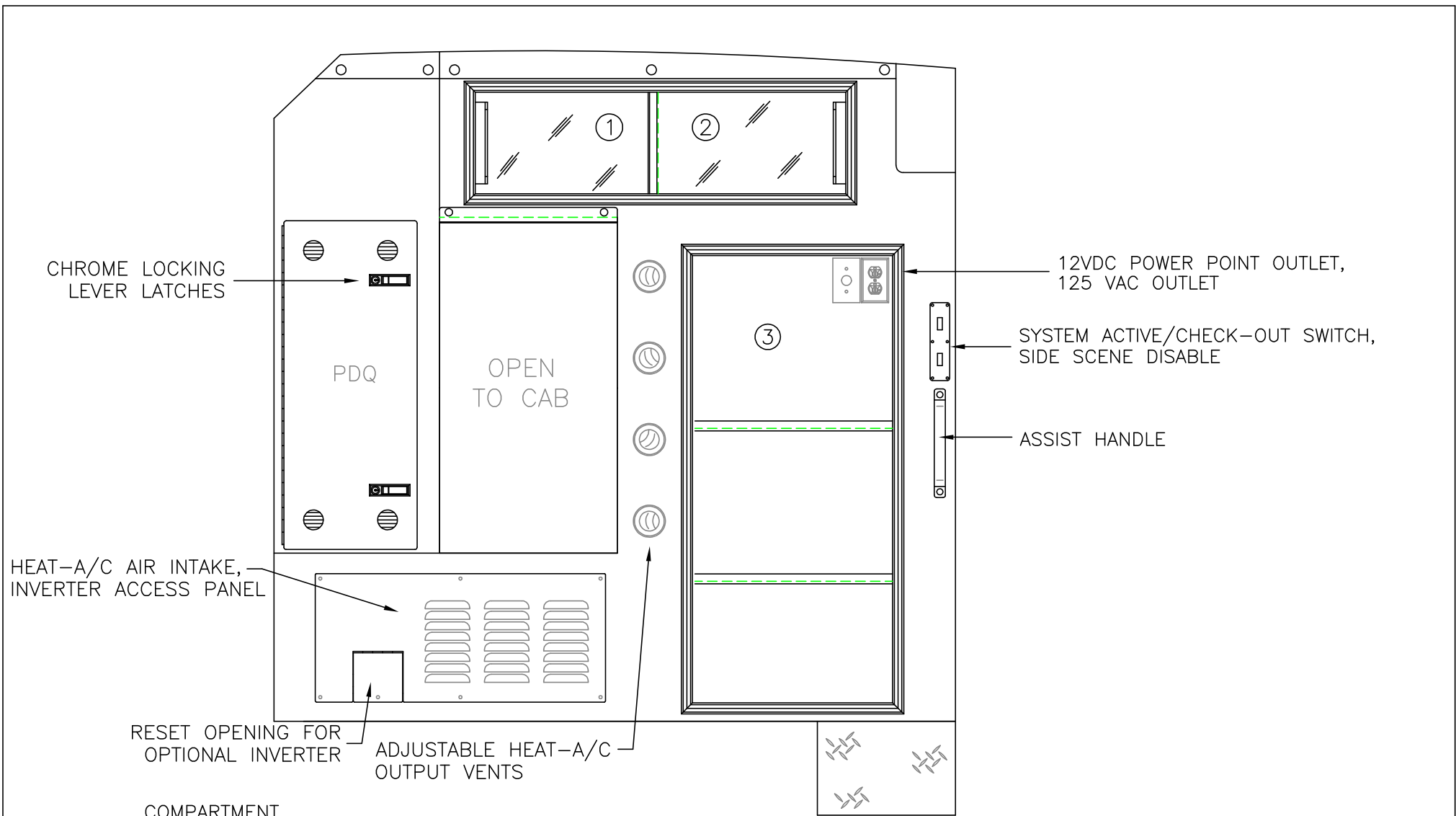

COMPARTMENT

#1/#2 DOOR OPENING: 10.25h x 38.00w
 INSIDE DIMS: 13.25h x 39.75w x 13.25d
 PERMANENT DIVIDER(CENTERED)

#3 OPENING: 45.25h x 20.25w
 INSIDE DIMS: 50.75h x 24.75w x 13.25d
 (2) ADJUSTABLE SHELVES

CABINETS TO BE ALUMINUM

CABINET SHELF TRACK TO BE RECESSED

THIS DRAWING IS FOR REPRESENTATIONAL PURPOSES ONLY. DETAILS ARE CONCEPTUAL AND ARE SUBJECT TO CHANGE DURING DESIGN AND CONSTRUCTION
 DIMENSIONS ARE APPROXIMATE UNLESS NOTED OTHERWISE TO MEET A SPECIFIC CUSTOMER NEED.



2014 PARTITION INTERIOR VIEW
 EXPRESS-III

1:14

DATE:	08 APR 13	
DWG.	GLF	REV. NR

DRAWING NO.	14EXE350-7
-------------	------------

OXYGEN ACCESS

RECESSED SHARPS/TRASH

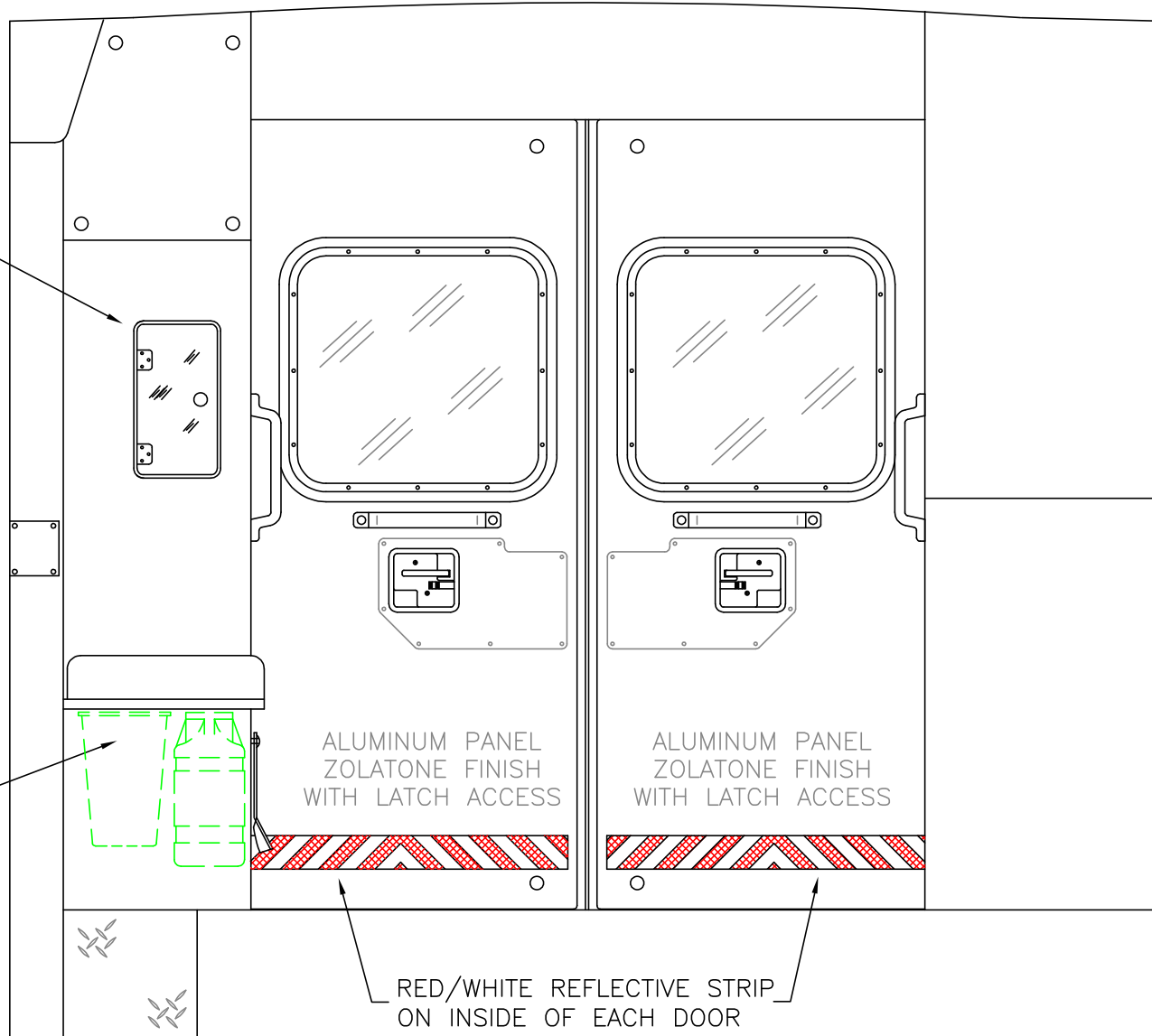

THIS DRAWING IS FOR REPRESENTATIONAL PURPOSES ONLY. DETAILS ARE CONCEPTUAL AND ARE SUBJECT TO CHANGE DURING DESIGN AND CONSTRUCTION DIMENSIONS ARE APPROXIMATE UNLESS NOTED OTHERWISE TO MEET A SPECIFIC CUSTOMER NEED.



2014 REAR INTERIOR VIEW
EXPRESS-III

1:13

DATE:	08 APR 13
DWG.	GLF
REV.	NR

DRAWING NO.	14EXE350-8
-------------	------------

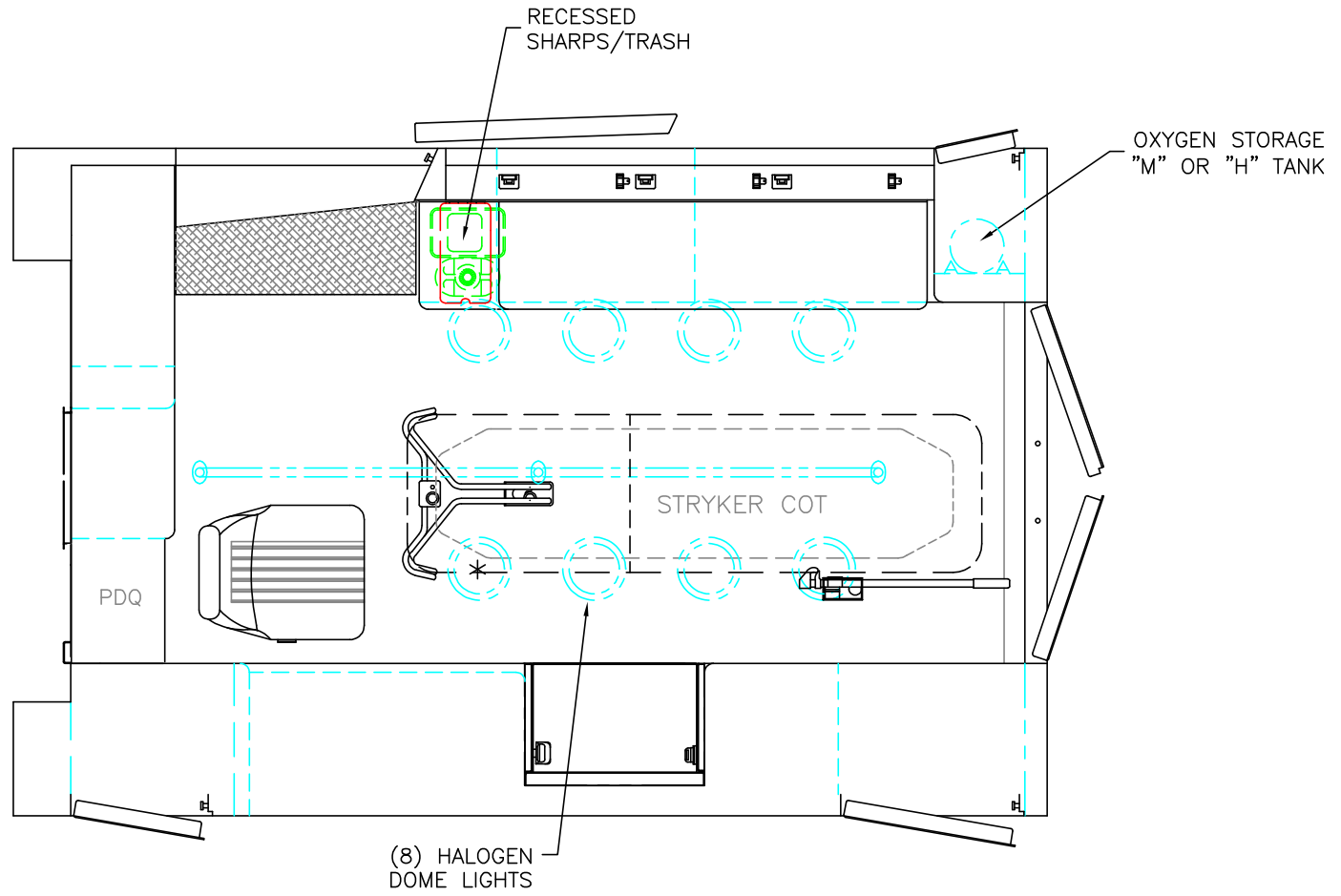

* (1) ANTENNA BASE LOCATED OUTBOARD OF DOME LIGHT WITH COAX SERVICE LOOP
 STRYKER CENTER MOUNT COT HARDWARE

HEAD ROOM = 68"
 OVERALL WIDTH WITH RUB
 RAILS & FENDERETTES = 95"
 MODULE LENGTH = 144"

THIS DRAWING IS FOR REPRESENTATIONAL PURPOSES ONLY. DETAILS ARE CONCEPTUAL AND ARE SUBJECT TO CHANGE DURING DESIGN AND CONSTRUCTION
 DIMENSIONS ARE APPROXIMATE UNLESS NOTED OTHERWISE TO MEET A SPECIFIC CUSTOMER NEED.



2014 FLOOR VIEW
 EXPRESS-III

1:24

DATE:	08 APR 13
DWG.	REV.
GLF	NR

DRAWING NO.
 14EXE350-9