

DIMENSIONS FOR OVERALL HEIGHT AND LENGTH ARE APPROXIMATE  
 OVERALL HEIGHT = 102.5"  
 OVERALL WIDTH WITH RUB  
 RAILS & FENDERETTES = 95"

(7) WHELEN 600 SUPER LED WITH CLEAR LENSES  
 RED / RED / RED / WHITE / RED / RED / RED

(5) TECNIQ S330 AMBER  
 MINI-LED MARKER LIGHTS

VELVAC 2020XG  
 HEATED/REMOTE  
 MIRRORS

FLASHING HEADLIGHTS W/  
 DAYTIME RUNNING LIGHTS

WHELEN 700 SERIES  
 RED SUPER LED  
 GRILLE LIGHTS  
 WITH CLEAR LENSES

CAST PRODUCTS  
 SAD/SAP 4316  
 SIREN SPEAKERS

THIS DRAWING IS FOR REPRESENTATIONAL PURPOSES ONLY. DETAILS ARE CONCEPTUAL AND ARE SUBJECT TO CHANGE DURING DESIGN AND CONSTRUCTION  
 DIMENSIONS ARE APPROXIMATE UNLESS NOTED OTHERWISE TO MEET A SPECIFIC CUSTOMER NEED.



2014 FRONT EXTERIOR VIEW  
 EXPRESS-III/G-3500

DATE:  
 08 APR 13  
 DWG. GLF  
 REV. NR

DRAWING NO.  
 14EXG3500-1

1:16

DIMENSIONS FOR OVERALL HEIGHT AND LENGTH ARE APPROXIMATE  
 OVERALL HEIGHT = 102.5"  
 OVERALL WIDTH WITH RUB  
 RAILS & FENDERETTES = 95"  
 FLOOR HEIGHT = 32.5"

(5) WHELEN 600 SUPER LED WARNING LIGHTS WITH CLEAR LENSES,  
 (2) WHELEN 600 CLEAR HALOGEN LOAD LIGHTS:  
 RED / RED / LOAD / AMBER / LOAD / RED / RED

(5) TECNIQ S330 RED  
 MINI-LED MARKER LIGHTS

EXHAUST VENT

LOCATION FOR  
 DOOR GRABBERS

LED LICENSE  
 PLATE LIGHT

(1) EACH SIDE, WHELEN  
 600 LED BRAKE/TAIL,  
 600 LED TURN  
 600 HALOGEN BACK-UP  
 NOTE: MOUNT OUTBOARD AS  
 FAR AS PRACTICAL

MUD FLAPS

INDEPENDENT BUMPER WITH  
 NON-SKID FLIP-UP CENTER  
 STEP AND COT PROTECTOR  
 ON STEP EDGE

THIS DRAWING IS FOR REPRESENTATIONAL PURPOSES ONLY. DETAILS ARE CONCEPTUAL AND ARE SUBJECT TO CHANGE DURING DESIGN AND CONSTRUCTION  
 DIMENSIONS ARE APPROXIMATE UNLESS NOTED OTHERWISE TO MEET A SPECIFIC CUSTOMER NEED.



2014 REAR EXTERIOR VIEW  
 EXPRESS-III

1:16

DATE:  
 08 APR 13  
 DWG. REV.  
 GLF NR

DRAWING NO.  
 14EXG3500-2

DIMENSIONS FOR OVERALL HEIGHT AND LENGTH ARE APPROXIMATE

OVERALL HEIGHT = 102.5"

OVERALL LENGTH = 254"

MODULE LENGTH = 144"

TECNIQ S330 RED MINI-LED MARKER LIGHT TO ALSO FLASH WITH TURN SIGNAL

WHELEN 700 RED SUPER LED W/CLEAR LENS INTERSECTION LIGHT

20 AMP SHORELINE INLET

WHELEN 900 RED SUPER LED WARNING LIGHTS WITH CLEAR LENSES

WHELEN 900 8-32 CLEAR SCENE LIGHTS

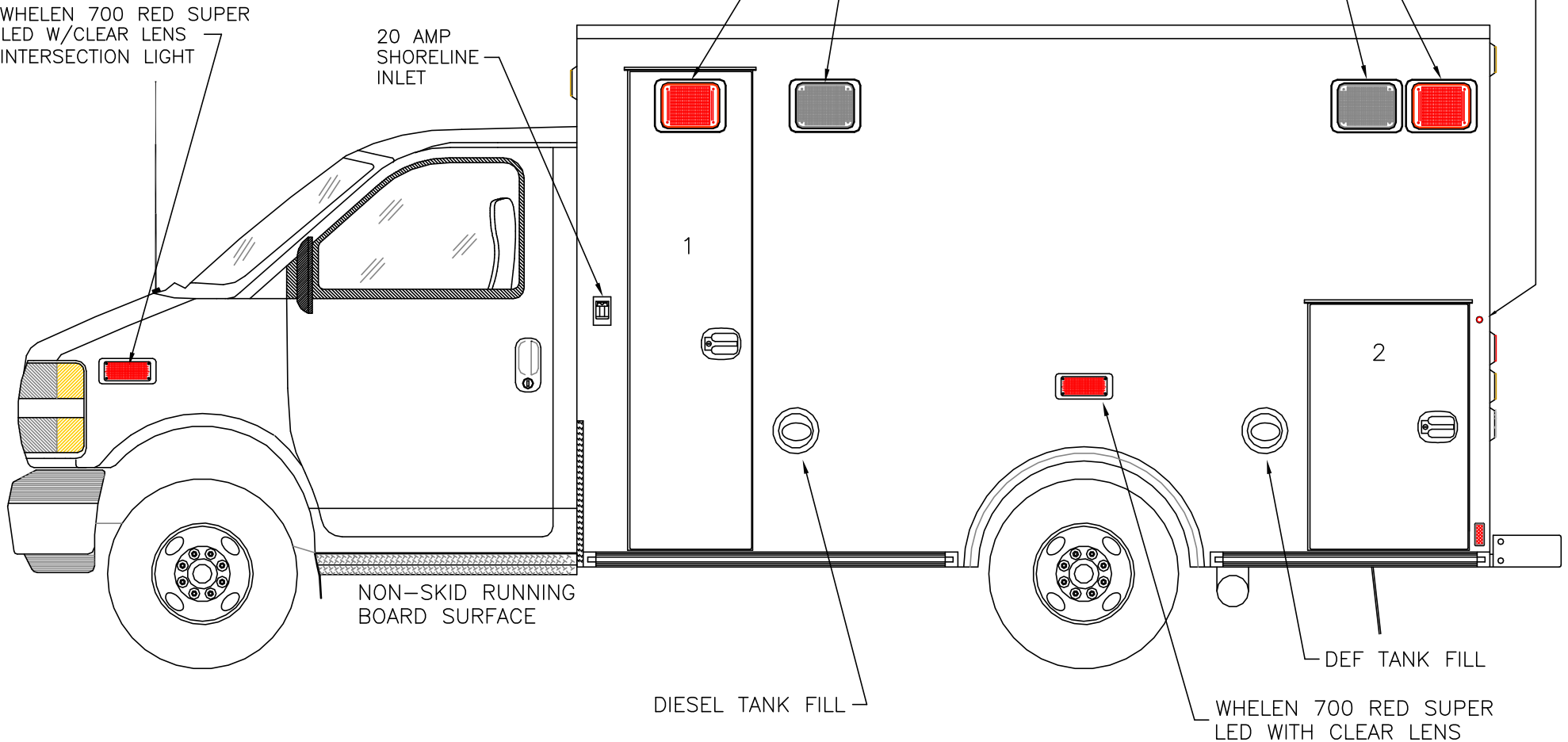

NON-SKID RUNNING BOARD SURFACE

DIESEL TANK FILL

DEF TANK FILL

WHELEN 700 RED SUPER LED WITH CLEAR LENS

COMPARTMENT

O.S.S #1

CLEAR OPENING: 74.00h x 16.00w

INSIDE DIMS: 75.00h x 22.75w x 18.50d

BACKBOARD/SCOOP STORAGE

O.S.S #2

CLEAR OPENING: 37.50h x 22.00w

INSIDE DIM'S.: 42.50h x 25.50w x 18.50d

THIS DRAWING IS FOR REPRESENTATIONAL PURPOSES ONLY. DETAILS ARE CONCEPTUAL AND ARE SUBJECT TO CHANGE DURING DESIGN AND CONSTRUCTION DIMENSIONS ARE APPROXIMATE UNLESS NOTED OTHERWISE TO MEET A SPECIFIC CUSTOMER NEED.



2014 STREETSIDE EXTERIOR VIEW  
EXPRESS-III/G-3500

1:24

DATE:	08 APR 13
DWG.	GLF
REV.	NR

DRAWING NO.	14EXG3500-3
-------------	-------------

DIMENSIONS FOR OVERALL HEIGHT AND LENGTH ARE APPROXIMATE  
 OVERALL HEIGHT = 102.5"  
 OVERALL LENGTH = 254"  
 MODULE LENGTH = 144"

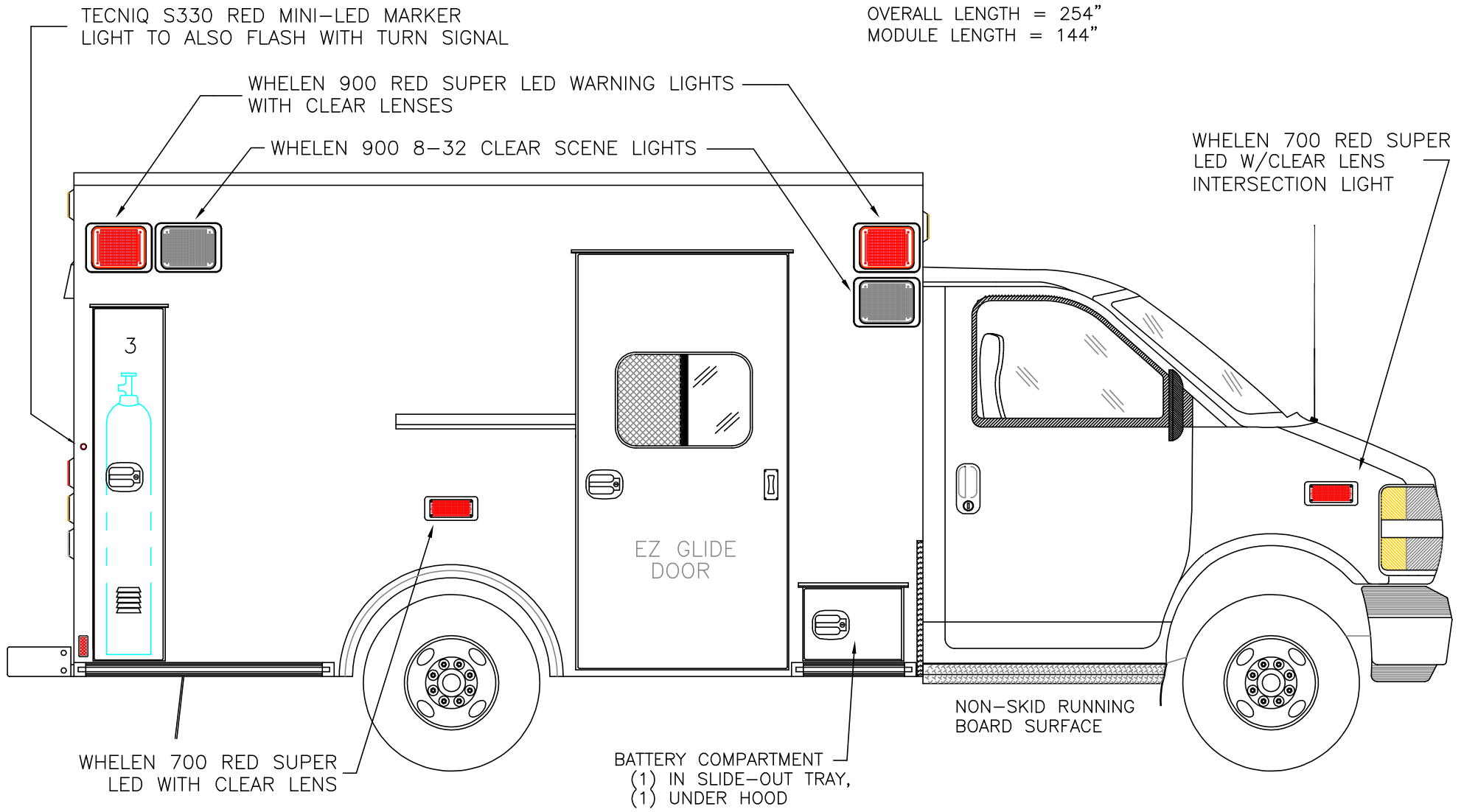

TECNIQ S330 RED MINI-LED MARKER LIGHT TO ALSO FLASH WITH TURN SIGNAL

WHELEN 900 RED SUPER LED WARNING LIGHTS WITH CLEAR LENSES

WHELEN 900 8-32 CLEAR SCENE LIGHTS

WHELEN 700 RED SUPER LED W/CLEAR LENS INTERSECTION LIGHT

3

EZ GLIDE DOOR

NON-SKID RUNNING BOARD SURFACE

WHELEN 700 RED SUPER LED WITH CLEAR LENS

BATTERY COMPARTMENT  
 (1) IN SLIDE-OUT TRAY,  
 (1) UNDER HOOD

O.S.S #3  
 CLEAR OPENING: 58.50h x 9.50w  
 INSIDE DIM'S.: 59.25h x 12.00w x 15.00d  
 OXYGEN COMPARTMENT FOR "M" OR "H" CYLINDER

THIS DRAWING IS FOR REPRESENTATIONAL PURPOSES ONLY. DETAILS ARE CONCEPTUAL AND ARE SUBJECT TO CHANGE DURING DESIGN AND CONSTRUCTION  
 DIMENSIONS ARE APPROXIMATE UNLESS NOTED OTHERWISE TO MEET A SPECIFIC CUSTOMER NEED.



2014 CURB EXTERIOR VIEW  
 EXPRESS-III/G-3500

DATE: 08 APR 13	DRAWING NO. 14EXG3500-4
DWG. GLF	REV. NR

1:24

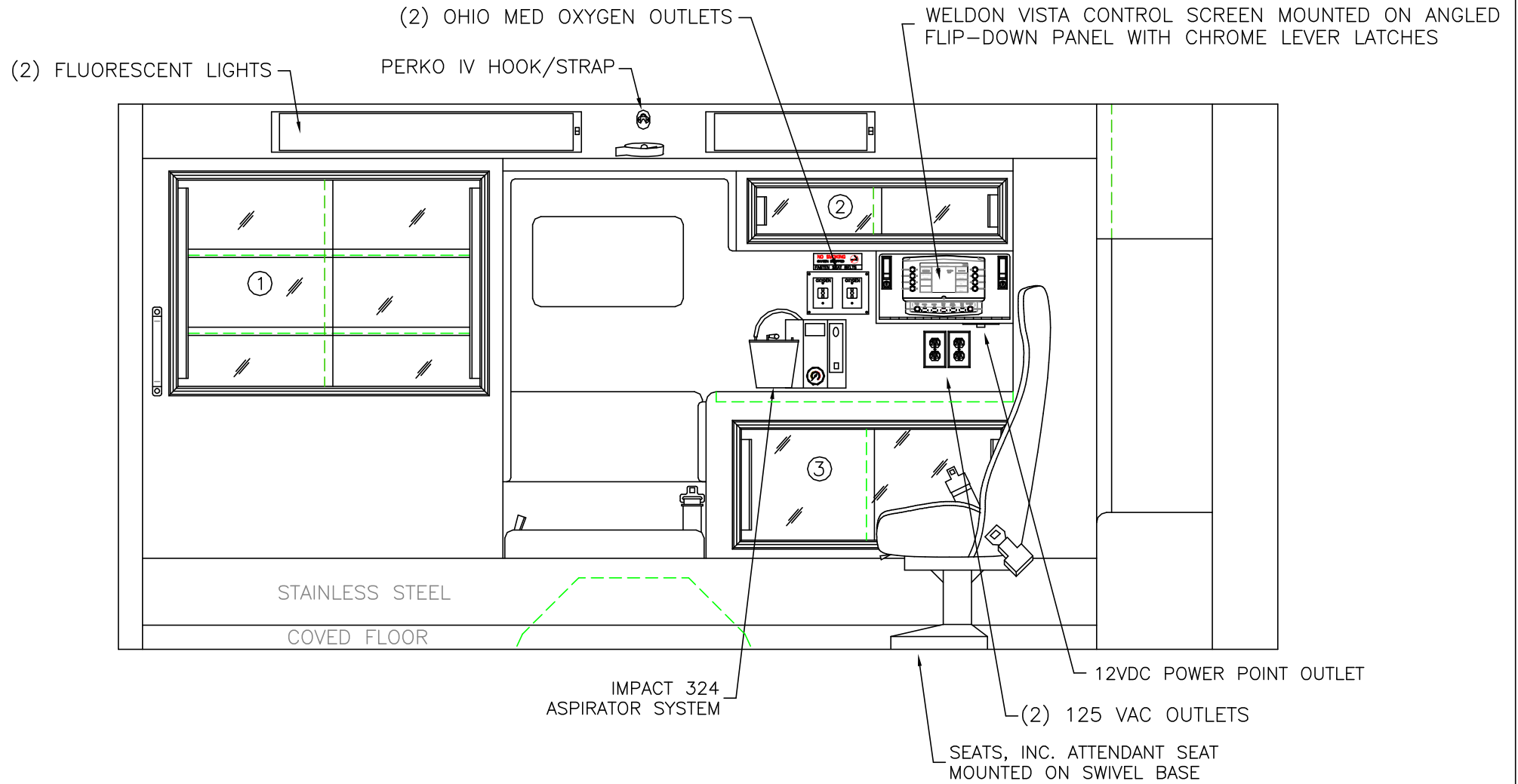

COMPARTMENT:

- #1 DOOR OPENING: 25.50h x 37.50w  
INSIDE DIMS: 27.50h x 39.50w x 16.25d  
(2) ADJUSTABLE SHELVES
- #2 DOOR OPENING: 5.75h x 30.00w  
INSIDE DIMS: 8.50h x 31.75w x 15.00d
- #3 DOOR OPENING: 13.75h x 32.25w  
INSIDE DIMS: 17.50h x 34.25w x 16.25d

CABINETS TO BE ALUMINUM  
CABINET SHELF TRACK TO BE RECESSED

THIS DRAWING IS FOR REPRESENTATIONAL PURPOSES ONLY. DETAILS ARE CONCEPTUAL AND ARE SUBJECT TO CHANGE DURING DESIGN AND CONSTRUCTION DIMENSIONS ARE APPROXIMATE UNLESS NOTED OTHERWISE TO MEET A SPECIFIC CUSTOMER NEED.



2014 STREETSIDE INTERIOR WITH CPR SEAT  
EXPRESS-III

1:18

DATE:	08 APR 13
DWG.	GLF
REV.	NR

DRAWING NO.	14EXG3500-5
-------------	-------------

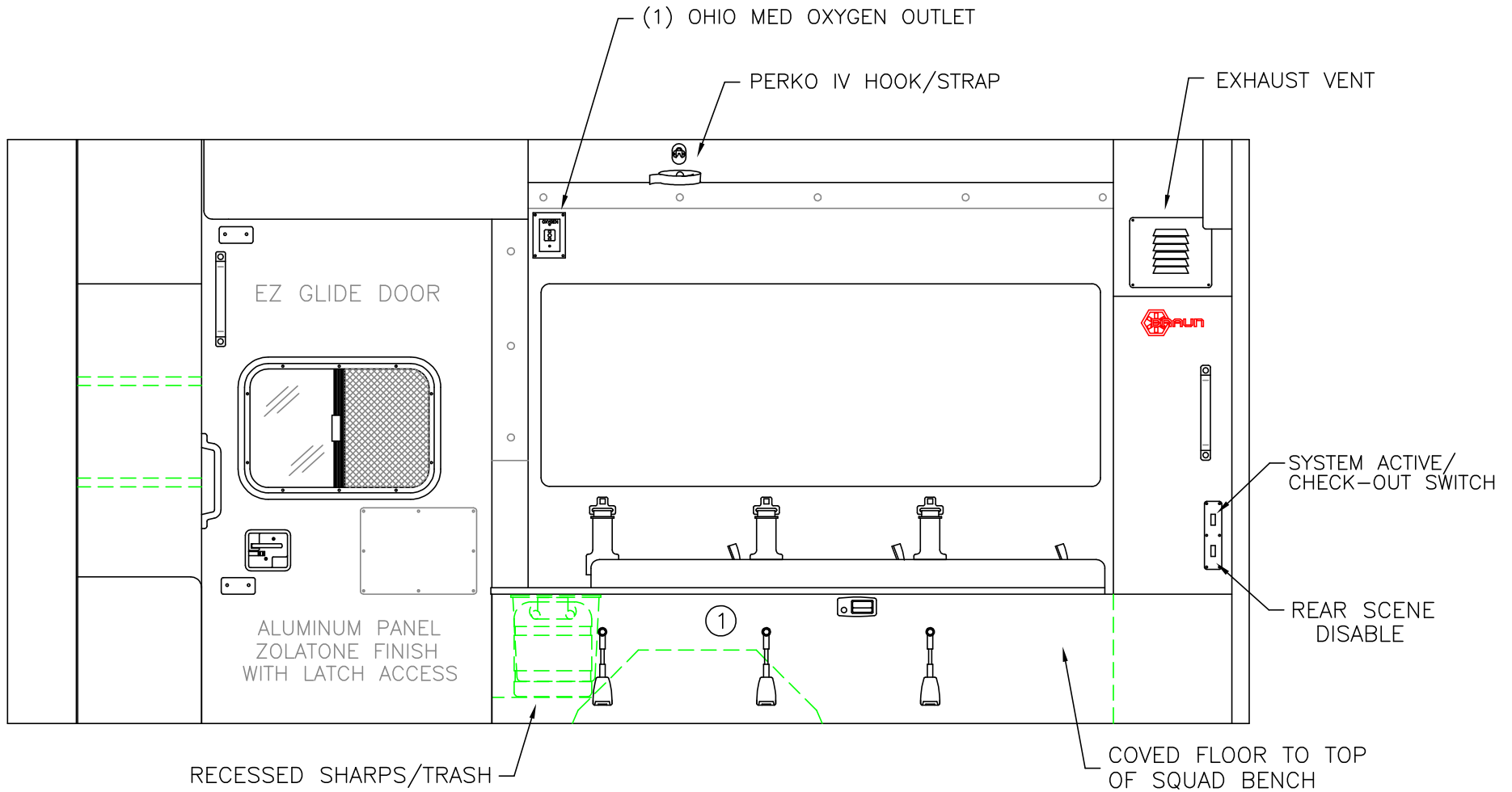

COMPARTMENT  
 #1 INSIDE DIMS: 15.50h x 72.00w x 18.50d

CABINETS TO BE ALUMINUM

THIS DRAWING IS FOR REPRESENTATIONAL PURPOSES ONLY. DETAILS ARE CONCEPTUAL AND ARE SUBJECT TO CHANGE DURING DESIGN AND CONSTRUCTION DIMENSIONS ARE APPROXIMATE UNLESS NOTED OTHERWISE TO MEET A SPECIFIC CUSTOMER NEED.



2014 CURBSIDE INTERIOR VIEW  
 EXPRESS-III

DATE: 08 APR 13		DRAWING NO.
DWG. GLF	REV. NR	14EXG3500-6

1:18

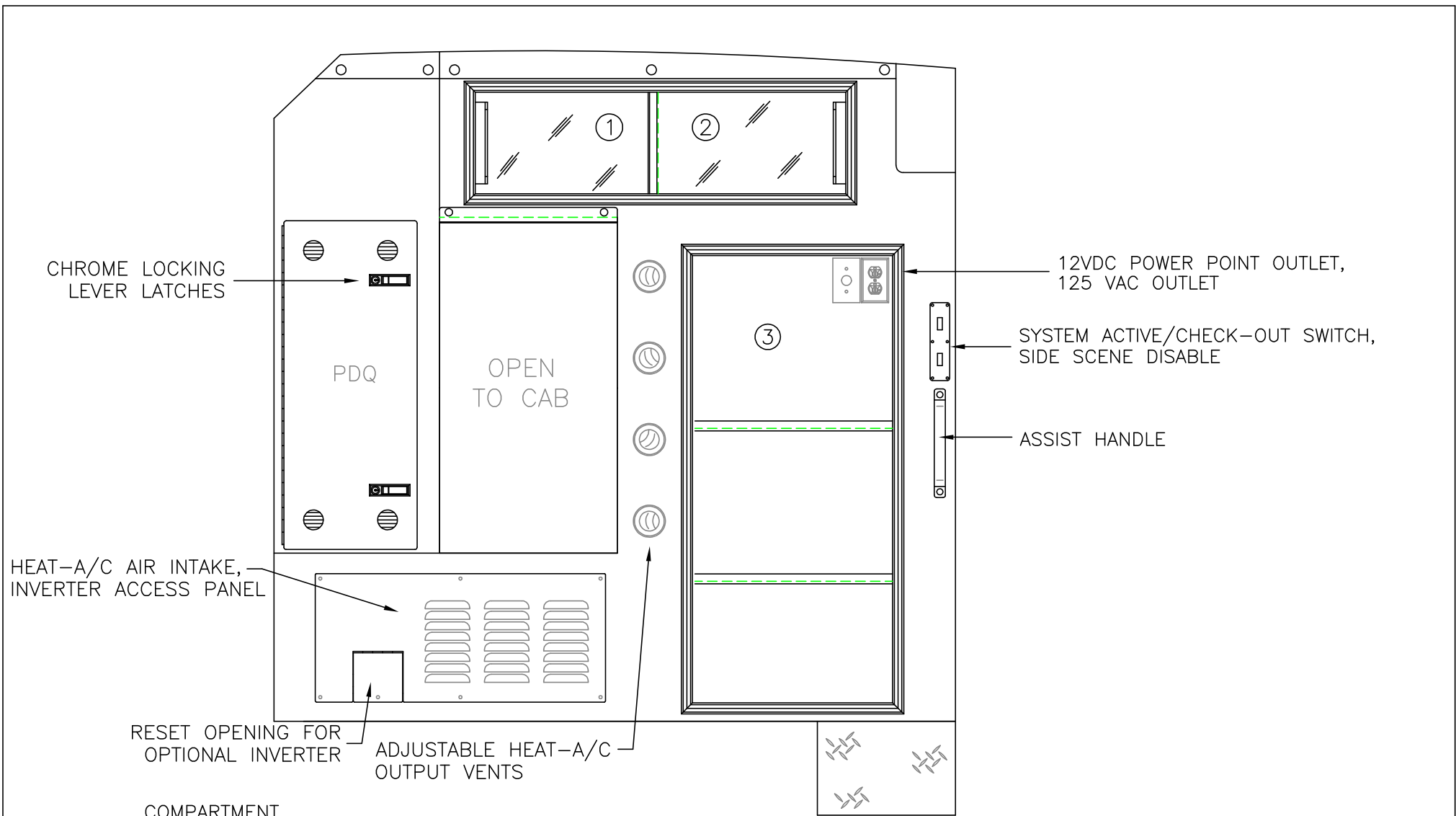

CHROME LOCKING  
LEVER LATCHES

HEAT-A/C AIR INTAKE,  
INVERTER ACCESS PANEL

RESET OPENING FOR  
OPTIONAL INVERTER

ADJUSTABLE HEAT-A/C  
OUTPUT VENTS

COMPARTMENT

#1/#2 DOOR OPENING: 10.25h x 38.00w  
INSIDE DIMS: 13.25h x 39.75w x 13.25d  
PERMANENT DIVIDER(CENTERED)

#3 OPENING: 45.25h x 20.25w  
INSIDE DIMS: 50.75h x 24.75w x 13.25d  
(2) ADJUSTABLE SHELVES

12VDC POWER POINT OUTLET,  
125 VAC OUTLET

SYSTEM ACTIVE/CHECK-OUT SWITCH,  
SIDE SCENE DISABLE

ASSIST HANDLE

CABINETS TO BE ALUMINUM

CABINET SHELF TRACK TO BE RECESSED

THIS DRAWING IS FOR REPRESENTATIONAL PURPOSES ONLY. DETAILS ARE CONCEPTUAL AND ARE SUBJECT TO CHANGE DURING DESIGN AND CONSTRUCTION  
DIMENSIONS ARE APPROXIMATE UNLESS NOTED OTHERWISE TO MEET A SPECIFIC CUSTOMER NEED.



2014 PARTITION INTERIOR VIEW  
EXPRESS-III

1:14

DATE:	08 APR 13	
DWG.	GLF	REV. NR

DRAWING NO.	14EXG3500-7
-------------	-------------

OXYGEN ACCESS

RECESSED SHARPS/TRASH

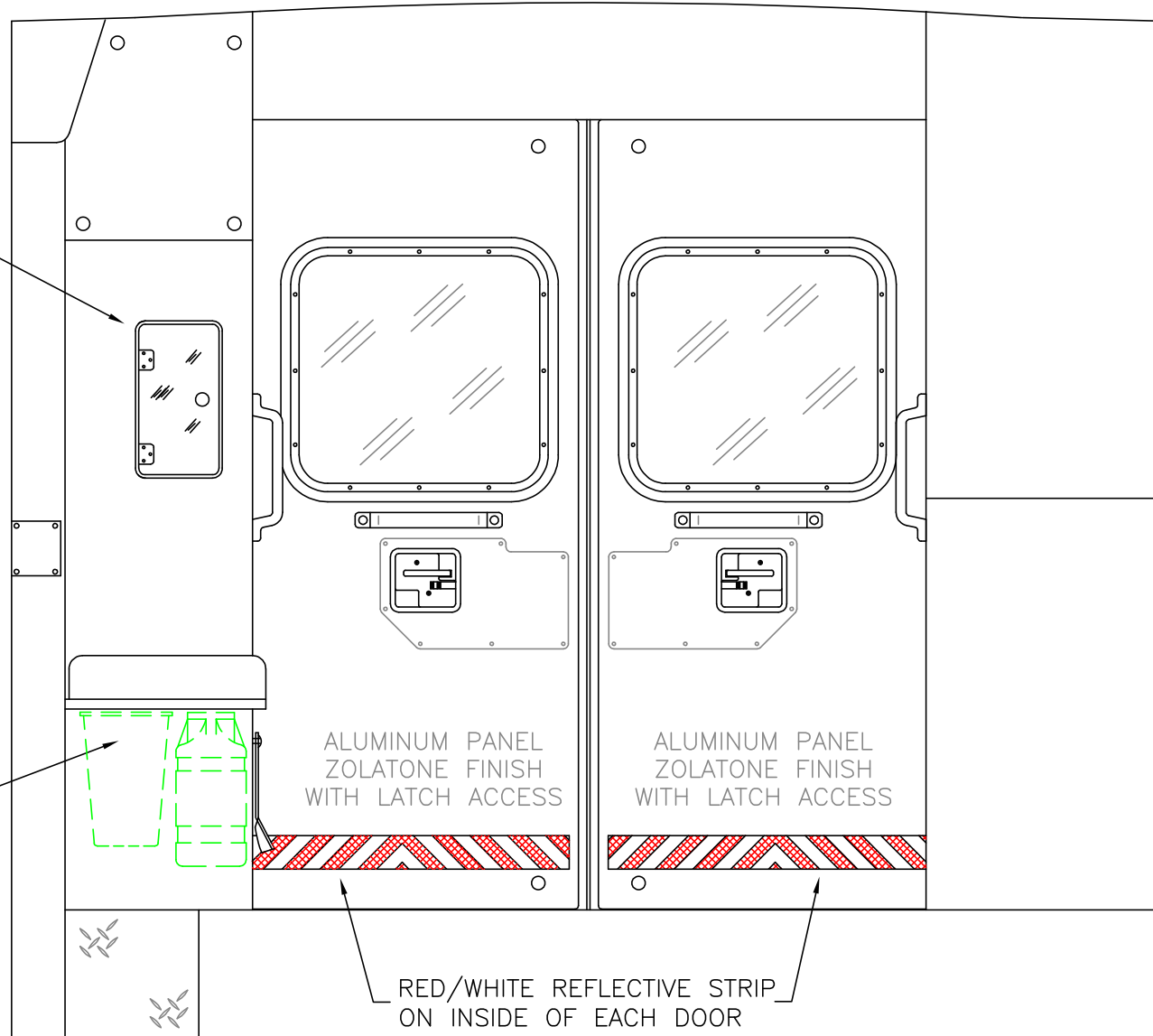

THIS DRAWING IS FOR REPRESENTATIONAL PURPOSES ONLY. DETAILS ARE CONCEPTUAL AND ARE SUBJECT TO CHANGE DURING DESIGN AND CONSTRUCTION DIMENSIONS ARE APPROXIMATE UNLESS NOTED OTHERWISE TO MEET A SPECIFIC CUSTOMER NEED.



2014 REAR INTERIOR VIEW  
EXPRESS-III

1:13

DATE:  
08 APR 13  
DWG. GLF REV. NR

DRAWING NO.  
14EXG3500-8



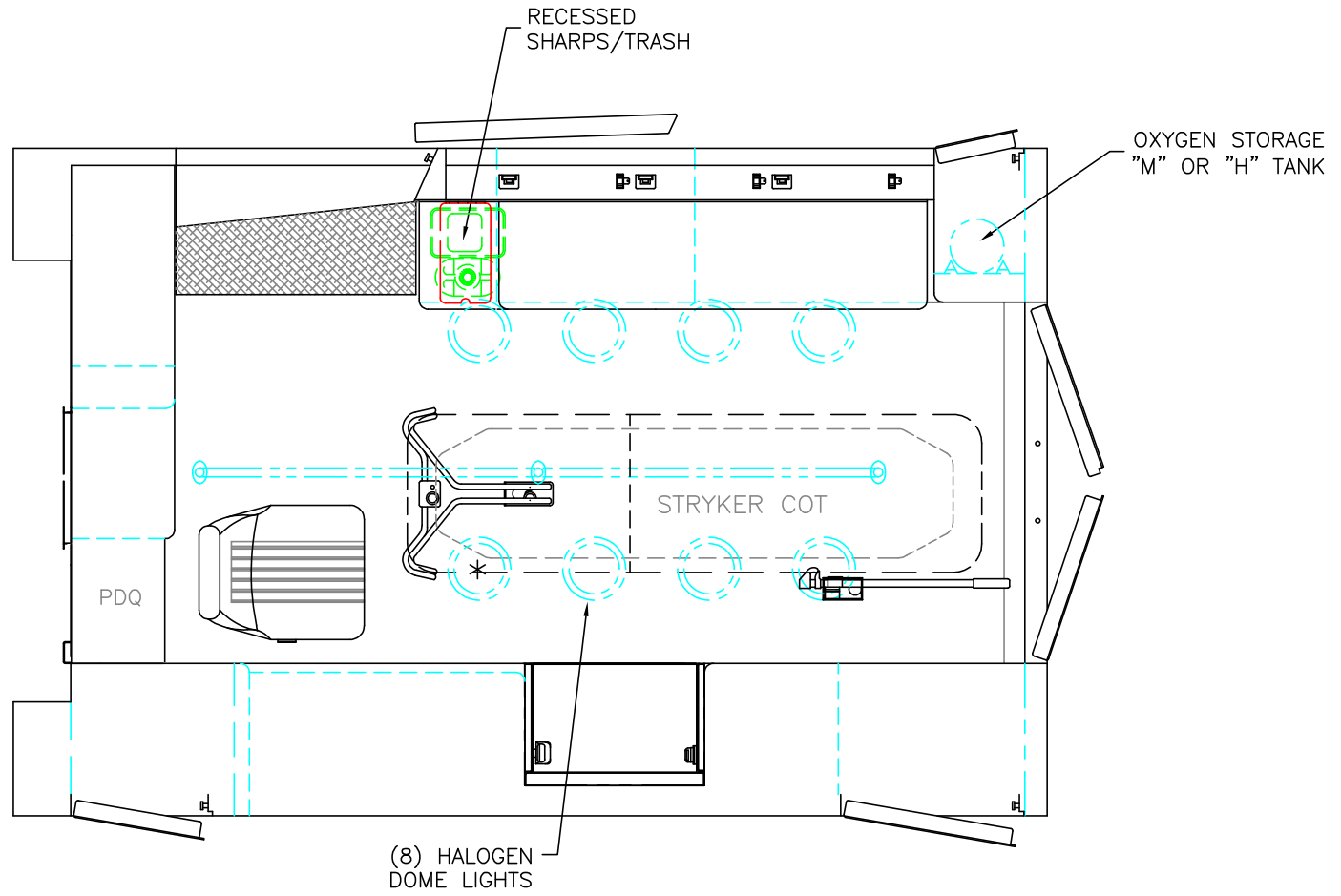

\* (1) ANTENNA BASE LOCATED OUTBOARD OF DOME LIGHT WITH COAX SERVICE LOOP

STRYKER CENTER MOUNT COT HARDWARE

HEAD ROOM = 68"  
 OVERALL WIDTH WITH RUB  
 RAILS & FENDERETTES = 95"  
 MODULE LENGTH = 144"

THIS DRAWING IS FOR REPRESENTATIONAL PURPOSES ONLY. DETAILS ARE CONCEPTUAL AND ARE SUBJECT TO CHANGE DURING DESIGN AND CONSTRUCTION  
 DIMENSIONS ARE APPROXIMATE UNLESS NOTED OTHERWISE TO MEET A SPECIFIC CUSTOMER NEED.



2014 FLOOR VIEW  
 EXPRESS-III

1:24

DATE:	08 APR 13
DWG.	REV.
GLF	NR

DRAWING NO.	14EXG3500-9
-------------	-------------